

Designed by Steve Durr and constructed by Chris McCollum. Main monitors designed by Steve Durr and constructed by Travis Smith with components from Altec, TAD, Trinnov, and Bag End. Vintage Crown amps. MTRX DADman monitor control. Focal Trio6 Be nearfields.

Console/Control Surface

Avid System 6 M40-32-9-D, Avid HDX with 16 channels of DAD converters, 32 channels of Avid converters, 32 faders, display modules and 9 knobs per channel.

Tape: Studer A827 24-track (< 5000 hours, reconditioned by Steve Smith)

Microphones (45)

Condenser:

AKG C414B (2)
 AKG C451B (2)
 Audio-Technica AT4033/CL (2)
 Beyerdynamic MC930 (2)
 Blue Kiwi (2)
 Miktek CV4 tube (2)
 Neumann KM184 (2)
 Neumann KM185 (2)
 Neumann M149 tube
 Neumann U47fet
 Neumann U87ai (2)
 sE sE4400a (2)
 Shure Beta91A kick drum (2)
 Telefunken AR51 tube

Ribbon:

AEA R44CE British update
 AEA R84 (2)
 Cloud 44A
 Rode NTR
 Royer R-122 (2)
 sE VooDoo VR2 (2)
 sE RNR1 Active (2)
 Vintage RCA 77-DX

Dynamic:

AKG D12 VR kick drum
 Sennheiser e609 Silver (2)
 Sennheiser MD 421 II (4)
 Shure SM57 (5)

Instruments and amps

Yamaha C7 concert grand
 Yamaha Motif XF
 Kurzweil 2600 with 88 weighted keys
 Fender Stratocaster
 Fender Precision Bass
 Fender Twin Reverb (tubes, 69 reissue)
 Fender Mustang
 Les Paul 70s reissue
 Les Paul Melody Maker
 Roland V-drums with mesh heads and TD-50 sound module
 Deford Bailey signature harmonica

Mic Preamps (30)

API 3124MB+	(4)
Shadow Hills Mono GAMA	(4)
LaChappell tube	(2)
Rupert Neve Portico 517	(2)
CS Syren tube	(2)
Focusrite Red	(2)
Radial Precomp	(2)
Sunset Sound Tutti	(2)
Cloudlifter CL-1	(2)
Radial Powertube	(2)
SSL Alpha VHD	(4)
SSL VHD	(2)

Channel Strips (10)

Avalon VT-737sp	
Rupert Neve Portico II	(2)
Rupert Neve Shelford Channel	(2)
Trident 80B	(2)
Universal Audio 6176	
Chandler Abbey Road	
Manley Core tube	

Compressors and Other

Elysia compressors	(2)
CS Falcon compressors	(2)
dbx 560 compressors	(2)
Lexicon MX-200	
Avid Eleven Rack	
MXR Bass DI+ Pedal	
Line 6 Helix	
Rupert Neve Master Bus Compressor	

Plugins

Hundreds from Avid, Universal Audio, Waves, Wave Arts, Antares, Celemony, Eventide, Focusrite, FabFilter, Izotope, Native Instruments, Plugin Alliance, Vir2, Softube, SoundToys, Slate Digital, Sonnox, Drumagog, Synchro Arts, others.

Hardware DSP

Avid HDX
UAD-2 Shark Octo

tPc studios NASHVILLE

Studio 4a

Control Room 12 x 17 - approx 204 sq ft
Tracking Room 15 x 19 - 285 sq ft

• TRACKING ROOM •
(vaulted ceiling)

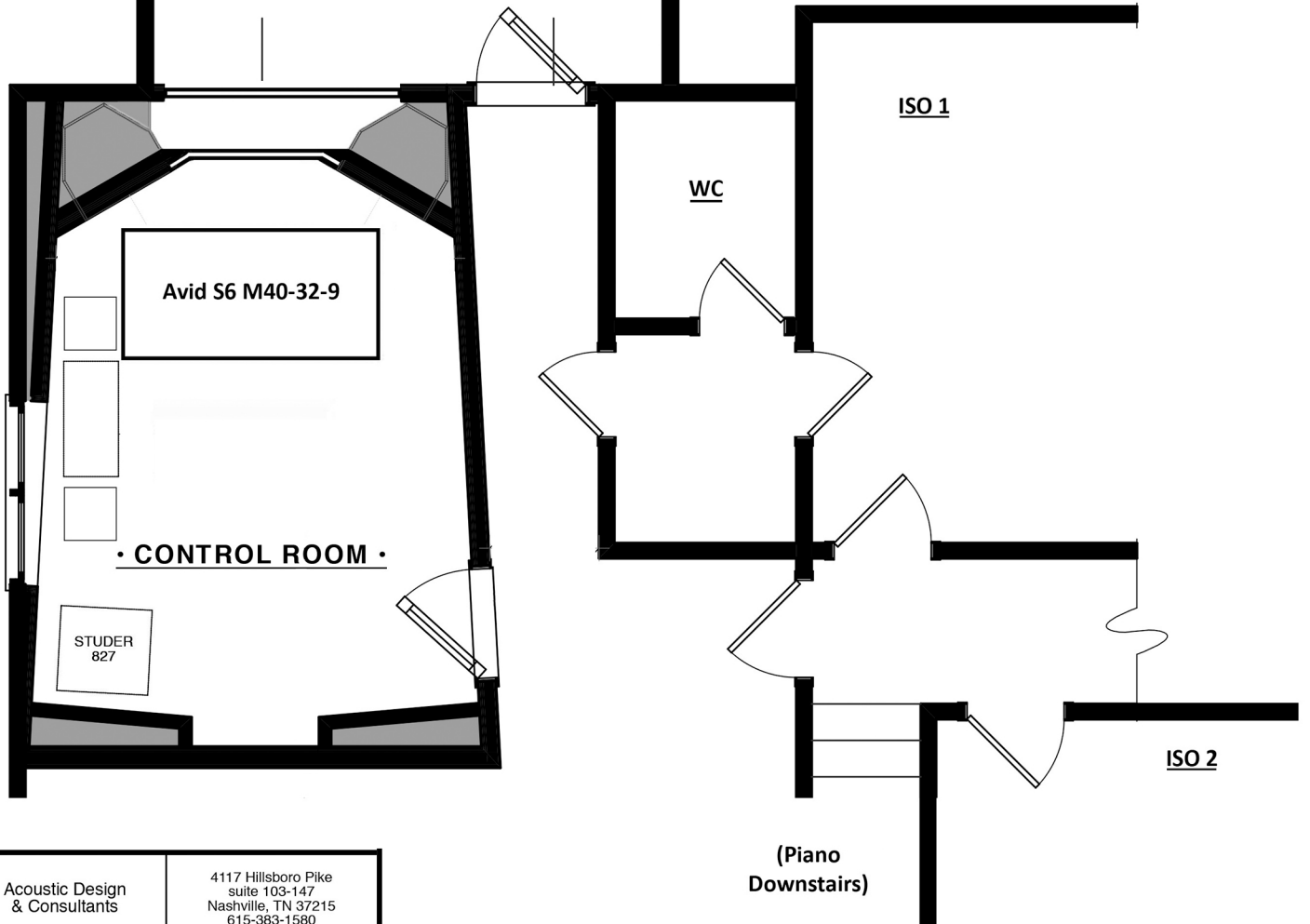

Acoustic Design
& Consultants

4117 Hillsboro Pike
suite 103-147
Nashville, TN 37215
615-383-1580

steven durr designs

CONSULTING - SOUND REINFORCEMENT - ROOM ACOUSTICS - STUDIO DESIGN - NOISE CONTROL

Patchbay Map

MIC / LINE TR FRONT								MIC / LINE TR BACK								MIC / LINE TR WINDOW AND LR								MIC / LINE CR AND BOOTHS																							
1	2	3	4	5	6	7	8	9	10	11	12	13	14	15	16	17	18	19	20	21	22	23	24	25	26	27	28	29	30	31	32																
MIC PREAMP IN								CHAN IN		6176 IN		SYREN IN		RED PRE IN		PWRTUBE IN		TUTTI IN		PREAMP LINE IN				SHADOW HILLS GAMA IN				R NEVE 517 IN		SSL VHD IN		API PRE IN				SSL VHD ALPHA IN											
AVAL	MAN	PORT1	PORT2	SHEL1	SHEL2	80B1	80B2	CHAN	6176	LC1	LC2	COMP	LINE	COMP	1	2	1	2	1	2	1	2	AVAL	MAN	PORT1	PORT2	SHEL1	SHEL2	80B1	80B2	1	2	4	4	1	2	1	2	1	2	3	4	1	2	2	4	
24-TRACK OUT								24-TRACK OUT								24-TRACK OUT								PRECOMP IN		ELYSIA IN		FALCON IN		DBX 560 IN		MX200 IN						CASS OUT		OPT DISC OUT		MOBILE OUT		CPU OUT		TT PRE OUT	
1	2	3	4	5	6	7	8	9	10	11	12	13	14	15	16	17	18	19	20	21	22	23	24	L	R	L	R	1	2	1	2	L	R					L	R	L	R	L	R	L	R	L	R
SWITCHER INPUT A								SWITCHER INPUT A								SWITCHER INPUT A								PRECOMP OUT		ELYSIA OUT		FALCON OUT		DBX 560 OUT		MX200 OUT						STEREO 1		STEREO 2		STEREO 3		STEREO 4			
1	2	3	4	5	6	7	8	9	10	11	12	13	14	15	16	17	18	19	20	21	22	23	24	L	R	L	R	1	2	1	2	L	R					L	R	L	R	L	R	L	R		
MIC PREAMP OUT								CHAN OUT		6176 OUT		SYREN OUT		RED PRE OUT		PWRTUBE OUT		TUTTI OUT		80B INS SND		SHEL SC SND						TB OUT		API PRE OUT				SSL VHD ALPHA OUT													
AVAL	MAN	PORT1	PORT2	SHEL1	SHEL2	80B1	80B2	CHAN	6176	LC1	LC2	MID	PRE	1	2	1	2	1	2	1	2	1	2	1	2	1	2	1	2	1	2	1	2	1	2	1	2	3	4	1	2	3	4				
SWITCHER INPUT B								SWITCHER INPUT B								SWITCHER INPUT B								80B INS RTN		SHEL SC RTN						LB IN		TB IN													
1	2	3	4	5	6	7	8	9	10	11	12	13	14	15	16	17	18	19	20	21	22	23	24	1	2	1	2					L	R	L	R					L	R						
SWITCHER OUTPUT								SWITCHER OUTPUT								SWITCHER OUTPUT								MOTIF OUT		KURZ OUT		GUITARS		MBP OUT		SHADOW HILLS GAMA OUT				NEVE 517 OUT		SSL VHD OUT		V-DRUMS OUT							
1	2	3	4	5	6	7	8	9	10	11	12	13	14	15	16	17	18	19	20	21	22	23	24	L	R	L	R	H	ER	L	R	1	2	4	4	1	2	1	2	K	S	HH	T1	T2	T3	C	R
CONVERTER INPUT A								CONVERTER INPUT A								CONVERTER INPUT B								CONVERTER INPUT B				MBP		CONVERTER INPUT C								CONVERTER INPUT C									
1	2	3	4	5	6	7	8	9	10	11	12	13	14	15	16	1	2	3	4	5	6	7	8	9	10	11	12	13	14	L	R	1	2	3	4	5	6	7	8	9	10	11	12	13	14	15	16
CONVERTER OUTPUT C								CONVERTER OUTPUT C								CONVERTER OUTPUT B								CONVERTER OUTPUT B				MBP																			
1	2	3	4	5	6	7	8	9	10	11	12	13	14	15	16	1	2	3	4	5	6	7	8	9	10	11	12	13	14	L	R																
24-TRACK IN								24-TRACK IN								24-TRACK IN												MBP IN		PH REV IN		PH REV IN		PH REV IN		PH REV IN		MULT 1				MULT 2					
1	2	3	4	5	6	7	8	9	10	11	12	13	14	15	16	17	18	19	20	21	22	23	24	L	R	L	R	L	R	L	R	L	R	L	R	L	R	L	R	L	R	L	R	L	R	L	R