

Designed by Steve Durr and constructed by Chris McCollum. Main monitors designed by Steve Durr and constructed by Travis Smith with components from Altec, TAD, Trinnov, and Bag End. Vintage Crown amps. MTRX DADman monitor control.

Console/Control Surface

Avid System 6 M40-32-9-D, Avid HDX with 16 channels of DAD converters, 32 channels of Avid converters, 32 faders, display modules and 9 knobs per channel.

Tape: Studer A827 24-track (< 5000 hours, reconditioned by Steve Smith)

Microphones (45)

Condenser:

AKG C414B (2)
AKG C451B (2)
Audio-Technica AT4033/CL (2)
Beyerdynamic MC930 (2)
Blue Kiwi (2)
Miktek CV4 tube (2)
Neumann KM184 (2)
Neumann KM185 (2)
Neumann M149 tube
Neumann U47fet
Neumann U87ai (2)
sE sE4400a (2)
Shure Beta91A kick drum (2)
Telefunken AR51 tube

Ribbon:

AEA R44CE British update
AEA R84 (2)
Cloud 44A
Rode NTR
Royer R-122 (2)
sE VooDoo VR2 (2)
sE RNR1 Active (2)
Vintage RCA 77-DX

Dynamic:

AKG D12 VR kick drum
Sennheiser e609 Silver (2)
Sennheiser MD 421 II (4)
Shure SM57 (5)

Instruments and amps

Yamaha C7 concert grand
Yamaha Motif XF
Kurzweil 2600 with 88 weighted keys
Fender Stratocaster
Fender Twin Reverb (tubes, 69 reissue)
Fender Mustang
Les Paul 70s reissue
Les Paul Melody Maker
Roland V-drums with mesh heads and TD-50 sound module

Mic Preamps (30)

| | |
|-------------------------|-----|
| API 3124MB+ | (4) |
| Shadow Hills Mono GAMA | (4) |
| LaChappell tube | (2) |
| Rupert Neve Portico 517 | (2) |
| CS Syren tube | (2) |
| Focusrite Red | (2) |
| Radial Precomp | (2) |
| Sunset Sound Tutti | (2) |
| Cloudlifter CL-1 | (2) |
| Radial Powertube | (2) |
| SSL Alpha VHD | (4) |
| SSL VHD | (2) |

Channel Strips (10)

| | |
|------------------------------|-----|
| Avalon VT-737sp | |
| Rupert Neve Portico II | (2) |
| Rupert Neve Shelford Channel | (2) |
| Trident 80B | (2) |
| Universal Audio 6176 | |
| Chandler Abbey Road | |
| Manley Core tube | |

Compressors and Other

| | |
|-----------------------|-----|
| Elysia compressors | (2) |
| CS Falcon compressors | (2) |
| dbx 560 compressors | (2) |
| Lexicon MX-200 | |
| Avid Eleven Rack | |
| MXR Bass DI+ Pedal | |

Plugins

Hundreds from Avid, Universal Audio, Waves, Wave Arts, Antares, Celemony, Eventide, Focusrite, FabFilter, Izotope, Native Instruments, Plugin Alliance, Vir2, Softube, SoundToys, Slate Digital, Sonnox, Drumagog, Synchro Arts, others.

Hardware DSP

Avid HDX
Waves Digigrid DLS
UAD-2 Shark Octo

tRc studios NASHVILLE

Studio 4a

Control Room 12 x 17 - approx 204 sq ft
Tracking Room 15 x 19 - 285 sq ft

• TRACKING ROOM •
(vaulted ceiling)

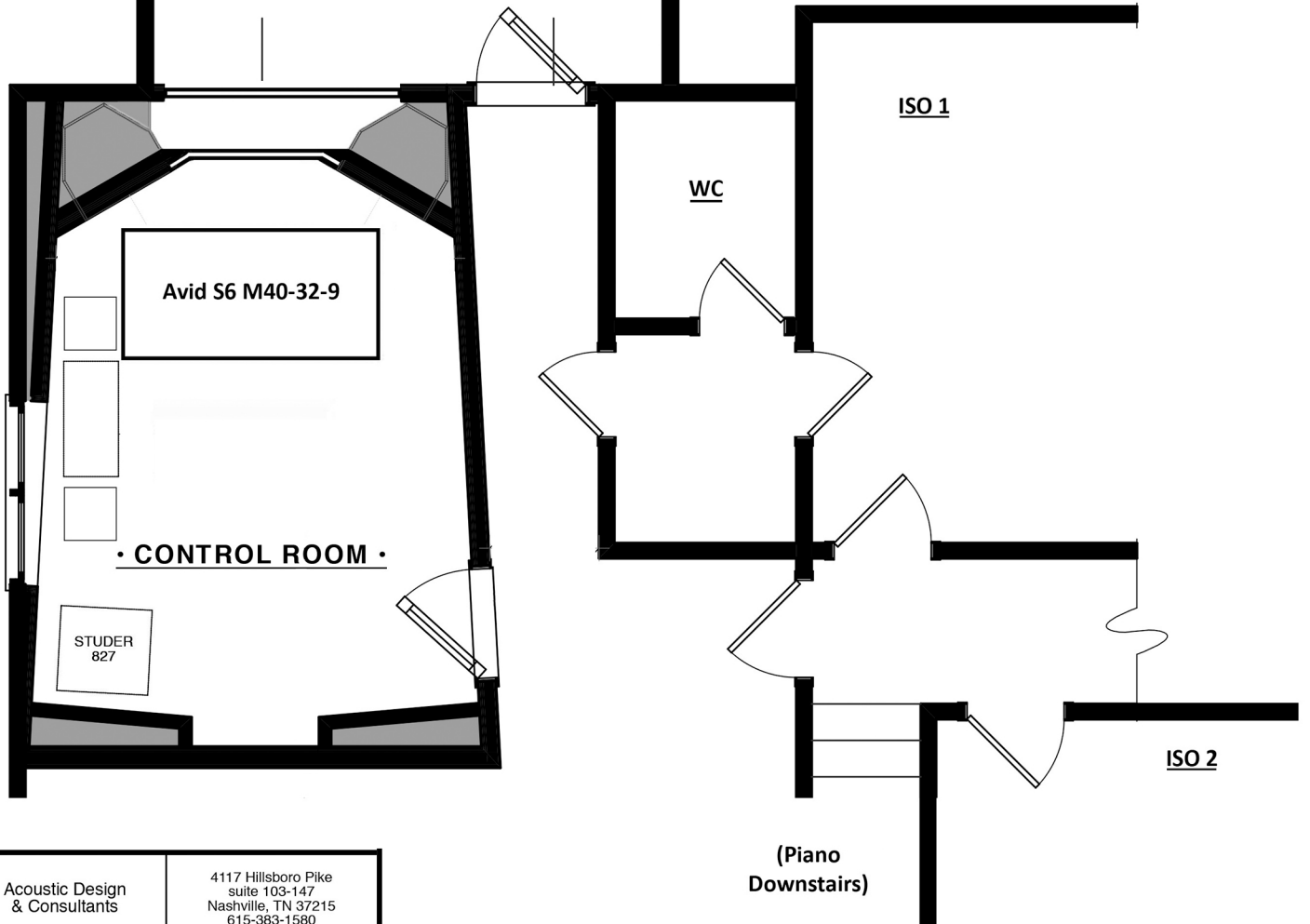

Acoustic Design
& Consultants

4117 Hillsboro Pike
suite 103-147
Nashville, TN 37215
615-383-1580

steven durr designs

CONSULTING - SOUND REINFORCEMENT - ROOM ACOUSTICS - STUDIO DESIGN - NOISE CONTROL

Patchbay Map

| | | | | | | | | | | | | | | | | | | | | | | | | | | | | | | | |
|------------------------------------------|--|--------------------|--|------------------------------------------|--|------------------|--|--------------------------------------------|--|--------------------|--|-----------------------|--|--------------------------------------|--|---------------------------------------------|--|----------------------------|--|-----------------------|--|--------------------|--|--------------------------------------------|--|-------------------|--|--------------------|--|---------------------|--|
| MIC / LINE 1 2 3 4 5 6 7 8 | | | | | | | | MIC / LINE 9 10 11 12 13 14 15 16 | | | | | | | | MIC / LINE 17 18 19 20 21 22 23 24 | | | | | | | | MIC / LINE 25 26 27 28 29 30 31 32 | | | | | | | |
| API PRE IN 1 2 3 4 | | | | PORTICO IN 1 2 | | 80B CS IN 1 2 | | SYREN PRE IN 1 2 | | RED PRE IN 1 2 | | PWRTUBE IN 1 2 | | TUTTI IN 1 2 | | SHADOW HILLS GAMA IN 1 2 4 4 | | | | R NEVE 517 IN 1 2 | | SSL VHD IN 1 2 | | PRECOMP IN 1 2 | | LACHAP IN 1 2 | | CASS OUT L R | | SPARE XLR B 1 2 | |
| 24-TRACK OUT 1 2 3 4 5 6 7 8 | | | | | | | | 24-TRACK OUT 9 10 11 12 13 14 15 16 | | | | | | | | 24-TRACK OUT 17 18 19 20 21 22 23 24 | | | | | | | | TT PRE OUT L R | | DAT OUT L R | | CPU OUT L R | | OPT DISC OUT L R | |
| SWITCHER INPUT A 1 2 3 4 5 6 7 8 | | | | | | | | SWITCHER INPUT A 9 10 11 12 13 14 15 16 | | | | | | | | SWITCHER INPUT A 17 18 19 20 21 22 23 24 | | | | | | | | STEREO 1 L R | | STEREO 2 L R | | STEREO 3 L R | | STEREO 4 L R | |
| API PRE OUT 1 2 3 4 | | | | PORTICO OUT 1 2 | | 80B OUT 1 2 | | SYREN PRE OUT 1 2 | | RED PRE OUT 1 2 | | PWRTUBE OUT 1 2 | | TUTTI OUT 1 2 | | SHADOW HILLS GAMA OUT 1 2 4 4 | | | | NEVE 517 OUT 1 2 | | SSL VHD OUT 1 2 | | PRECOMP OUT 1 2 | | LACHAP OUT 1 2 | | SPARE XLR C 1 2 | | SPARE XLR D 1 2 | |
| SWITCHER INPUT B 1 2 3 4 5 6 7 8 | | | | | | | | SWITCHER INPUT B 9 10 11 12 13 14 15 16 | | | | | | | | SWITCHER INPUT B 17 18 19 20 21 22 23 24 | | | | | | | | MOTIF OUT L R | | KURZ OUT L R | | SPARE XLR E L R | | SPARE XLR F L R | |
| SWITCHER OUTPUT 1 2 3 4 5 6 7 8 | | | | | | | | SWITCHER OUTPUT 9 10 11 12 13 14 15 16 | | | | | | | | SWITCHER OUTPUT 17 18 19 20 21 22 23 24 | | | | | | | | V-DRUM OUT 1 2 3 4 5 6 7 8 | | | | | | | |
| CONVERTER INPUT 1 2 3 4 5 6 7 8 | | | | | | | | CONVERTER INPUT 9 10 11 12 13 14 15 16 | | | | | | | | CONVERTER INPUT 17 18 19 20 21 22 23 24 | | | | | | | | CONVERTER INPUT 25 26 27 28 29 30 31 32 | | | | | | | |
| CONVERTER OUTPUT 1 2 3 4 5 6 7 8 | | | | | | | | CONVERTER OUTPUT 9 10 11 12 13 14 15 16 | | | | | | | | CONVERTER OUTPUT 17 18 19 20 21 22 23 24 | | | | | | | | MAIN OUT L R | | ALT OUT L R | | CUE 1 OUT L R | | CUE 2 OUT L R | |
| 24-TRACK IN 1 2 3 4 5 6 7 8 | | | | | | | | 24-TRACK IN 9 10 11 12 13 14 15 16 | | | | | | | | 24-TRACK IN 17 18 19 20 21 22 23 24 | | | | | | | | CR AMPS IN L R | | ATC AMP IN L R | | FB AMP IN L R | | WIRELESS IN L R | |
| ELYSIA IN L R | | CS COMP IN 1 2 | | DBX COMP IN 1 2 | | | | MX200 IN 1 2 | | 80B INS SND 1 2 | | 80B LINE IN 1 2 | | PORT LINE IN 1 2 | | UNIVERSAL AUDIO 6176 IN MIC LINE 1176 | | CHANDLER IN PRE/EQ COMP | | MANLEY IN MIC LINE | | | | | | | | | | | |
| ELYSIA OUT L R | | CS COMP OUT 1 2 | | DBX COMP OUT 1 2 | | | | MX200 OUT 1 2 | | 80B INS RTN 1 2 | | | | UNIVERSAL AUDIO 6176 OUT PRE 1176 | | CHAND OUT PRE/EQ COMP | | MANLEY OUT MIC LINE | | | | | | | | | | | | | |
| RND SHELFORD 1 IN MIC LINE SC RTN | | | | RND SHELFORD 2 IN MIC LINE SC RTN | | | | SSL VHD ALPHA IN 1 2 2 4 | | | | AVALON IN MIC LINE | | LB IN | | TB OUT | | PH REV IN OUT | | PH REV IN OUT | | PH REV IN OUT | | PH REV IN OUT | | | | | | | |
| RND SHELFORD 1 OUT LINE-6 LINE SC SND | | | | RND SHELFORD 2 OUT LINE-6 LINE SC SND | | | | SSL VHD ALPHA OUT 1 2 3 4 | | | | AVALON OUT LINE | | | | TB IN IN | | MULT 1 | | | | MULT 2 | | | | | | | | | |